

## Steps Performed by Student

Role	Tasks
 <b>Student</b>	<ul style="list-style-type: none"> <li>• Create MathWorks Account</li> <li>• Add the TAH Student license to your MathWorks Account</li> <li>• Install product files</li> <li>• Activate installation.</li> </ul>

### Step 1: Create a MathWorks Account

To activate the software, you must have a MathWorks Account. You can use an existing MathWorks Account, but the email address used for the account must include your university's email domain and the account must be set up for academic use.

You can create an account at the MathWorks Web site or during the installation process (see "Step 3: Install Product Files" on page 1-36).

To create an account at the MathWorks Web site, click the **Create Account** link. When you create the account, make sure to set it up for academic use, as shown in the following figure. Do not select the Student use option.

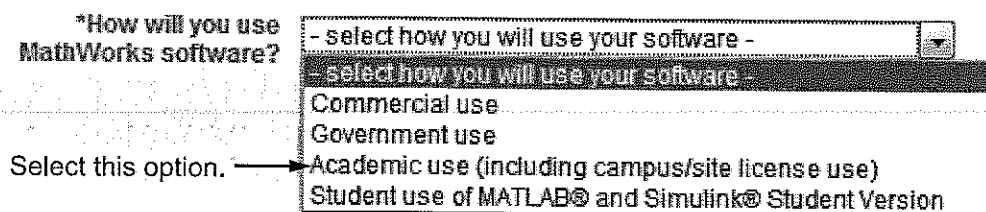

### Step 2: Add the TAH Student License to Your Account

To activate the software, you add the TAH Student license to your MathWorks Account (also called associating your MathWorks Account with the TAH Student license). To do this, use the Activation Key for the TAH Student license..

You can add the TAH Student license to your account using the License Center at the MathWorks Web site or during installation using the MathWorks installer (see “Step 3: Install Product Files” on page 1-36).

To add the TAH Student license to your account at the License Center, follow these instructions:

- 1 Log in to your MathWorks Account at the MathWorks Web site.
- 2 On the your Account Main Page, click **Manage Licenses**.
- 3 On the Licenses page, click **Add License**.

Click Add License.



- 4 In the Add License dialog box, select the Activation Key option and click **Continue**.

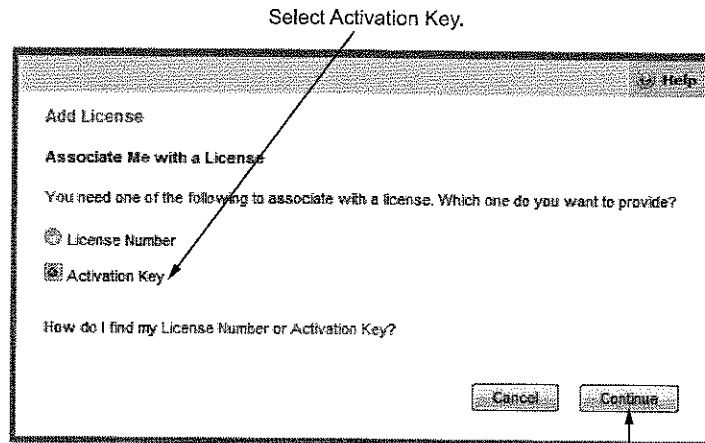

Click Continue.

- 5 Enter the Activation Key for the TAH Student license and click **Continue**.

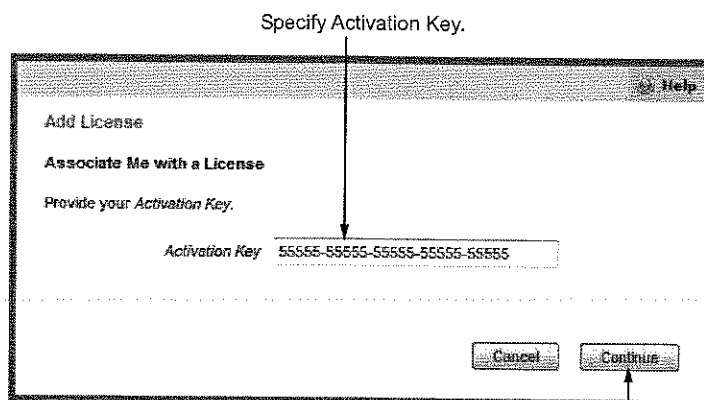

Click Continue.

### **Step 3: Install Product Files**

- 1** Get the Activation Key for the TAH Student license from your license administrator, along with any instructions they have prepared.
- 2** Get access to the product files. For example, the administrator at your site might give you the location of a server on your internal network where you can get the files. If your administrator wants you to download product files from MathWorks, follow this procedure:
  - Log in to your MathWorks Account at the MathWorks Web site. (If you need to create an account, see “Step 1: Create a MathWorks Account” on page 1-33.)
  - On your Account Main Page, click **Manage Licenses** to get to the License Center. To download products, you must add the TAH Student license to your MathWorks Account (see “Step 2: Add the TAH Student License to Your Account” on page 1-34).
  - On the Licenses page, select the TAH Student license and, in the License Details area, click **Download Products**. Follow the instructions on each dialog box in the download procedure.
- 3** Start the MathWorks installer:
  - Windows: Double-click the `setup.exe` file. If you have access to the product DVD, the installer starts automatically when you insert the DVD into the DVD drive connected to your computer.
  - Macintosh: Double-click the `InstallForMacOSX` file.
  - Linux/Unix: Run the `install.sh` script.

4 Choose to install automatically using the Internet and click **Next**.

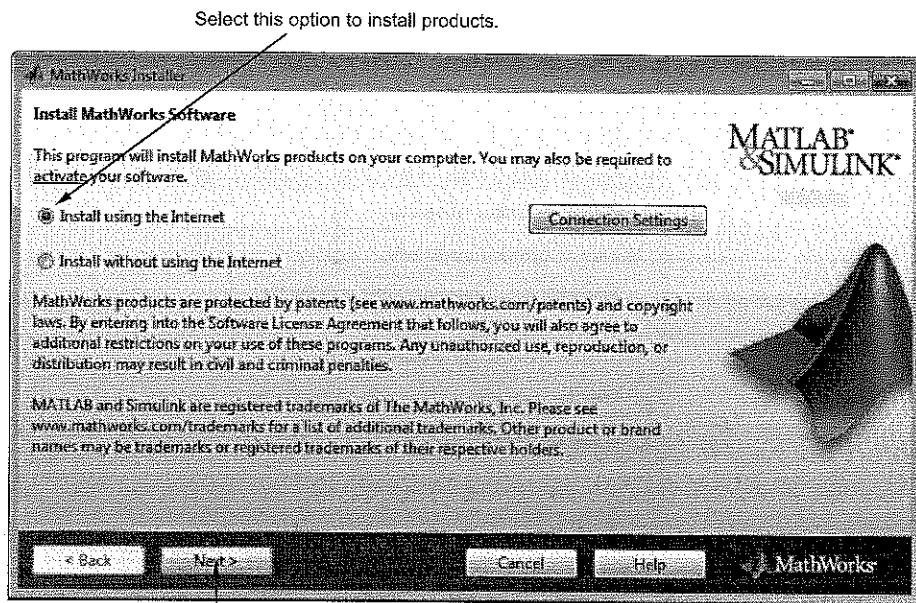

Click Next.

5 Review the software license agreement and click **Next**

- 6 Log in to your MathWorks Account, specifying your email address and password, or if you need to create an account, select the **I need to create a MathWorks Account** option and click **Next**.

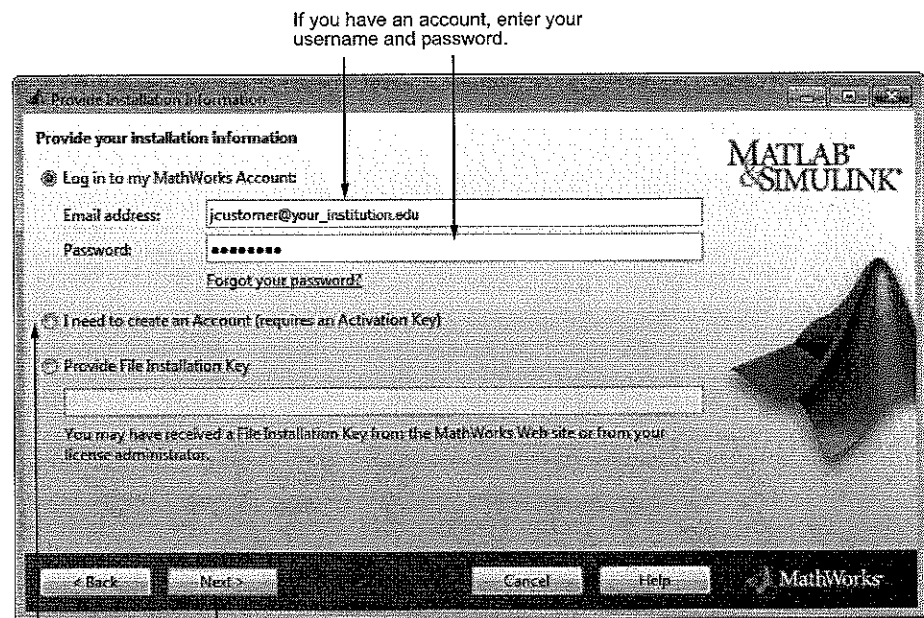

If you need to create an account, select this option. Click Next.

If you are creating a new account, enter your university email address, first name and last name, and define a password in the Account Creation dialog box. To create an account, you must associate it with a license. To do this, specify the Activation Key of the TAH Student license.

Enter your email address. Define a password.

Click Next. Enter Activation Key.

**Note** After you click **Next**, the installer displays the Email Verification Required dialog box. Before you can continue with the installation, you must verify your email address. Go to your email program, open the message sent to you by MathWorks, and click the verification link. Then return to the installation process and click **Next** to proceed with installation.

- 7 Specify the license you want to install in the License Selection dialog box.
  - If you have the Activation Key for the TAH Student license, select the **Enter an Activation Key for a license not listed** option and enter the Activation Key.
  - If you have already added the TAH Student license to your MathWorks Account, select the license from the list of licenses.
  - If you created an account in the previous step, the installer skips this step because you already specified the Activation Key.

After selecting the license, click **Next**.

Select the TAH Student license.

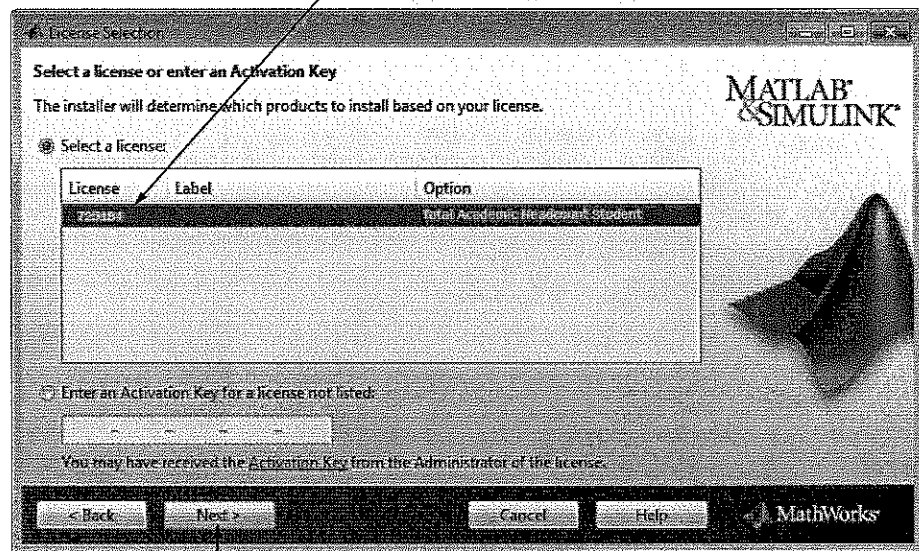

Click **Next**.

- 8 Select the **Typical** option in the Installation Type dialog box. This ensures that all products on the TAH Student license get installed.
- 9 Specify the folder in which you want to install the software and click **Next**.
- 10 Confirm your choices and click **Next**.
- 11 In the Installation Complete dialog box, click **Next** to proceed with activation of the software. You cannot use the software you installed until you activate it. If you want to activate later in a separate process, clear the option and click **Finish** (the button label changes if you clear the checkbox).



## Step 4: Activate the Software

- 1 In the MathWorks Software Activation dialog box, click **Next**

**Note** If you started the activation application, rather than letting the installer start it, you must choose whether to activate automatically or manually.

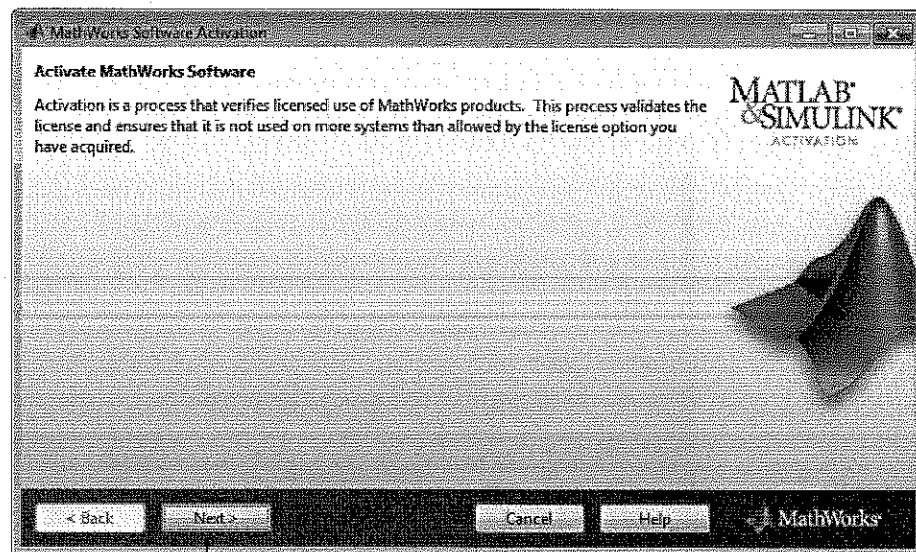

Click Next.

- 2 Log in to your MathWorks Account and click **Next**.

**Note** If you let the installer start the activation application and you were logged in to your account, the activation application skips this step.

- 3 Select the license you want to activate and click **Next**.

---

**Note** If you let the installer start the activation application and you were logged in to your account, the activation application skips this step.

---

- 4 Specify the Activation Key in the Activation Key dialog box and click Next.

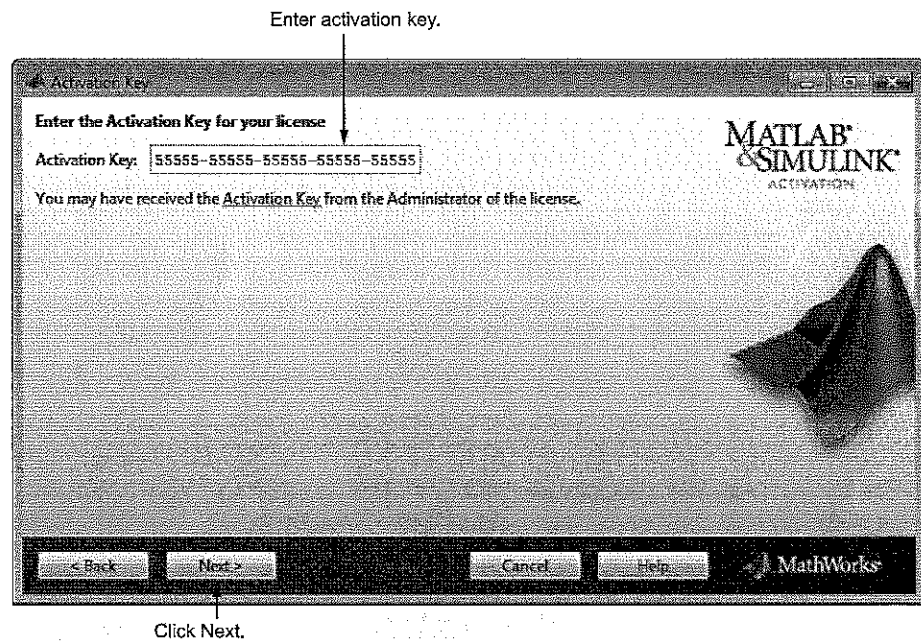

---

**Note** If the administrator of the license is performing the installation, the installer displays the Licensed End User dialog box. In this dialog, the administrator must specify the computer user name of the person who will use the software. A student installing the software will typically not see this dialog box.

---

- 5 Confirm your activation information in the Confirmation dialog box and click **Activate** to activate the software.

- 6 Complete the activation process by clicking **Finish** in the Activation Complete dialog box.

## Installing Child Licenses in a TAH Campus License

To add a product to a TAH license that you only want to be available to a select group on campus, you must purchase a *child license*. A child license is affiliated with the TAH Campus license but it is a separate license with a separate license number. To have a Child license, you must be a member of the faculty or staff of the institution and must be part of the TAH license.

To install and activate a child license, you must first install and activate the TAH Campus license. Follow this procedure:

- 1** Install the TAH Campus license on your computer and activate the installation, following the standard procedure, described in Chapter 1, “Administering a Total Academic Headcount License”
- 2** Install the additional products, as a separate installation, and activate the software. Follow this procedure:
  - a** Download the product files and run the MathWorks installer.
  - b** During installation, log in to your MathWorks Account, select the child license, and select the products you want to install.
  - c** When specifying the installation folder, specify the name of your existing TAH Campus installation folder.
  - d** Activate the child license.